

Ventilconvettore

Chilled Water Fan Coil Unit

1 ÷ 22 kW

120CFM ÷ 2400CFM

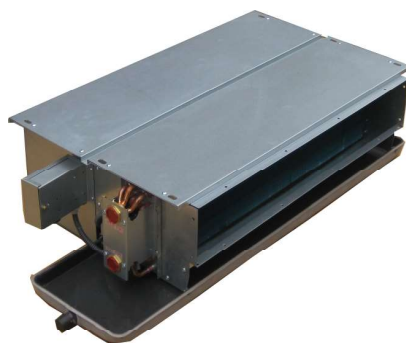

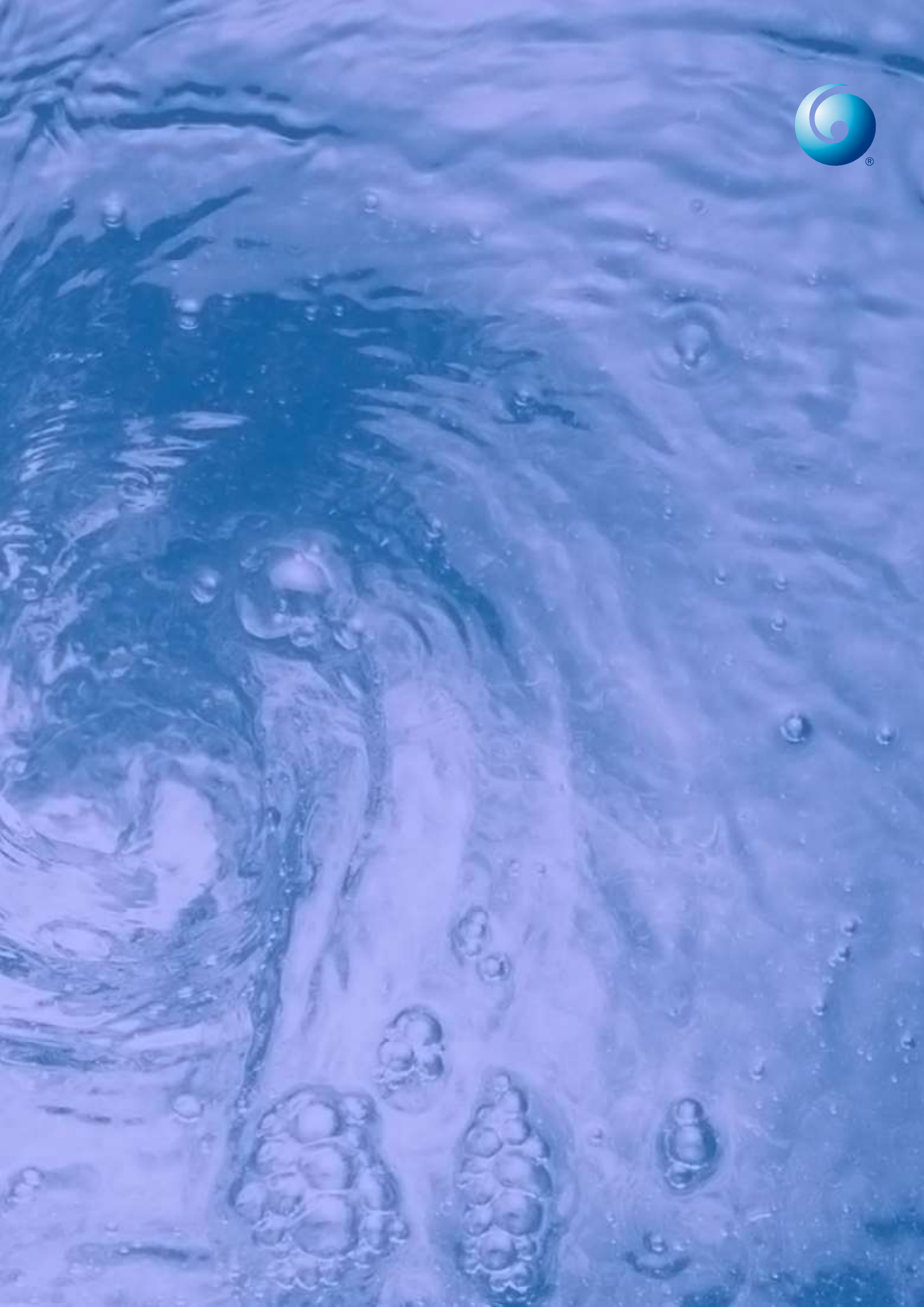

indice / contents

Nomenclatura / Nomenclature	2
La gamma / Product range	3
One-way cassette type fan coil	4
Four-way cassette type fan coil	6
Surround cassette type fan coil	8
Ceiling floor type fan coil	10
High wall mounted type fan coil	12
Duct concealed type fan coil	13
Duct high static pressure type fan coil	16
Universal type fan coil	18
Ultra-thin vertical type fan coil	20

AIRWAVE is well-known in the international air conditioning industry for its professional research and design, high quality products and aftersales service, originated from Italia in 2005. Today, AIRWAVE has grown into an international refrigeration & air conditioning products and system supplier, providing users all over the world with our reliable products, professional expert group and all-around prompt supporting services to meet customers' diverse needs on HVAC in commercial, industrial and residential fields.

AIRWAVE aims to users who have special demands on product quality, size and energy saving, etc. We are committed to provide them comprehensive services including system design, product development, project installation and after-sales support.

AIRWAVE brings great influences to the world around us in many ways. Our products are widely used in many countries and regions, including Europe, Russia, Middle East, South Asia, Middle Asia, South Africa, North Africa, etc. We provide not only comfortable sight experience, but also perfect energy-saving solutions, which are genuine benefits to the users.

Nomenclatura Nomenclature

V F C 2 0 0 K 4 L D 2 L 1 D C
 1 2 3 4 5 6 7 8 9 10 11 12 13 14 15

1: AIRWAVE

2&3: Product: Chilled Water Fan Coil Unit

4,5,6: Airflow: Number*10CFM

7,8: Type: C1 (1-way cassette), C4 (4-way cassette), C8 (surround cassette), HW (high wall mounted), CF (ceiling floor), DL (duct concealed low static), DL4 (duct concealed low static 4 rows), DH (duct high static), UB (universal bottom/rear inlet), UF (universal front/down inlet), UT (ultra-thin vertical)

9: Legs: L: with legs (universal vertical type only)

10: Installation: D: Decorative, C: Concealed

11: Pipe: 2: 2 pipes, 4: 4 pipes

12: Pipe connection: L: left, R: right

13: Power supply:

1=220V/1PH/50HZ 2=110V/1PH/60HZ 3=220V/1PH/60HZ

14,15: Motor: AC/DC/EC

Condizioni standard di raffreddamento:

Temperatura aria in ingresso D.B. t(d)=27°C W.B. t(w)=19.5°C ; temperatura acqua in ingresso=7°C ,temperatura acqua in uscita: t=12°C ,temperatura differenziale di acqua in ingresso e in uscita:t=5°C .

Condizioni standard di riscaldamento: Temperatura aria in ingresso D.B. t(d)=21°C ; Temperatura acqua calda in ingresso: t= 60°C ; temperatura acqua in uscita: t=50°C ,differenza: t=10°C.

I dati acustici sono stati rilevati alla distanza di 1 m da ciascuna unità.

Cooling standard condition: Air inlet temperature D.B. t(d)=27°C, W.B. t(w)=19.5°C ; water inlet temperature's=7°C ,water outlet temperature: t=12°C ,water inlet and outlet temperature difference: t=5°C .

Heating standard condition: Air inlet temperature D.B. t(d)=20°C ; Hot water input temperature: t= 60°C ; water outlet temperature: t=50°C ,difference: t=10°C.

La gamma Product range

Model	20	30	40	50	60	80	90	100	120	140	160	200	240	DC motor (0-10V) Optional	EC motor (3 speed)
Air flow (CFM)	200	300	400	500	600	800	900	1000	1200	1400	1600	2000	2400		
1-way cassette type	•	•	•	•											
4-way cassette type	•	•	•	•	•	•	•	•	•	•				•	
Surround cassette type	•	•	•	•	•	•		•	•	•					
High wall mounted type	•	•	•	•	•	•									
Ceiling floor type		•	•	•	•	•		•	•	•					
Duct concealed type	•	•	•	•	•	•		•	•	•				•	•
Duct high static pressure type						•		•	•	•	•	•	•		
Universal decorative type	•	•	•	•	•	•		•	•	•				•	•
Universal concealed type	•	•	•	•	•	•		•	•	•				•	•
Ultra thin vertical decorative type	•	•	•	•	•									•	
Ultra thin vertical concealed type	•	•	•	•	•									•	

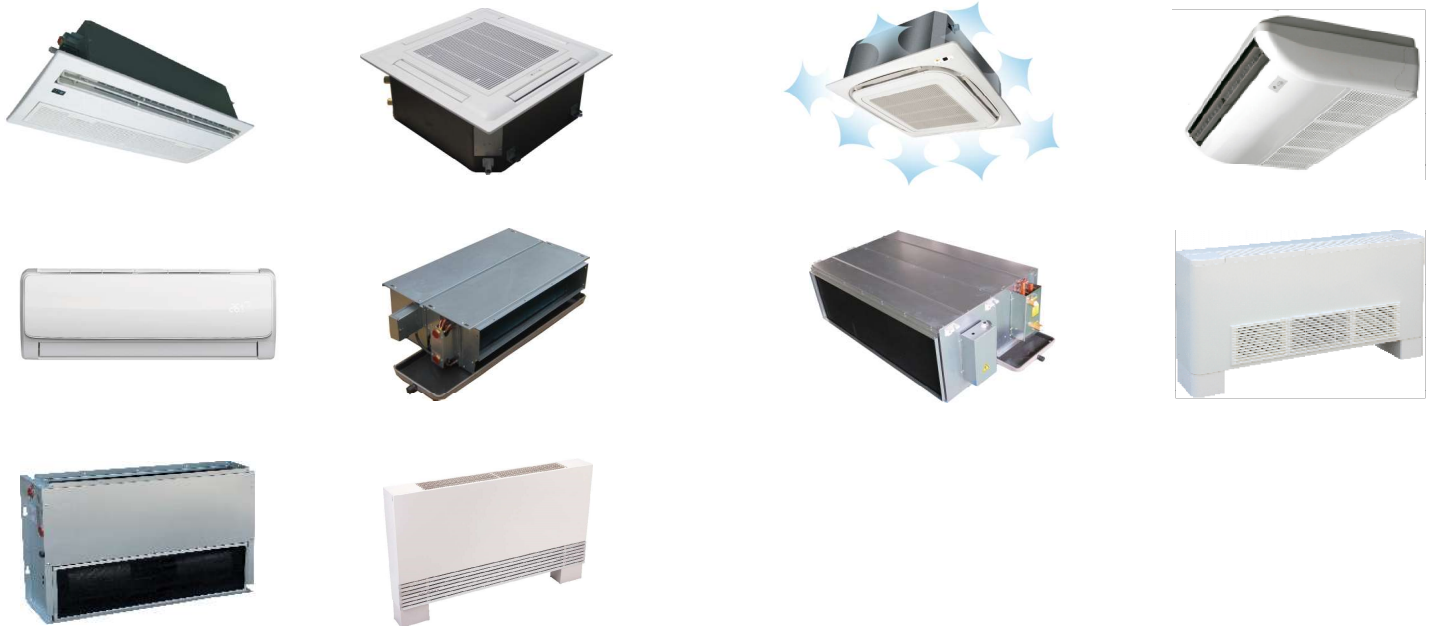

One-way cassette type fan coil



- With remote controller, optional wiring controller;
- Auto swing;
- With high head drain pump;
- Float switch inside to prevent from leaking;
- Optional fresh air function;
- Optional MODBUS protocol.

Dimensioni Dimension

Left style

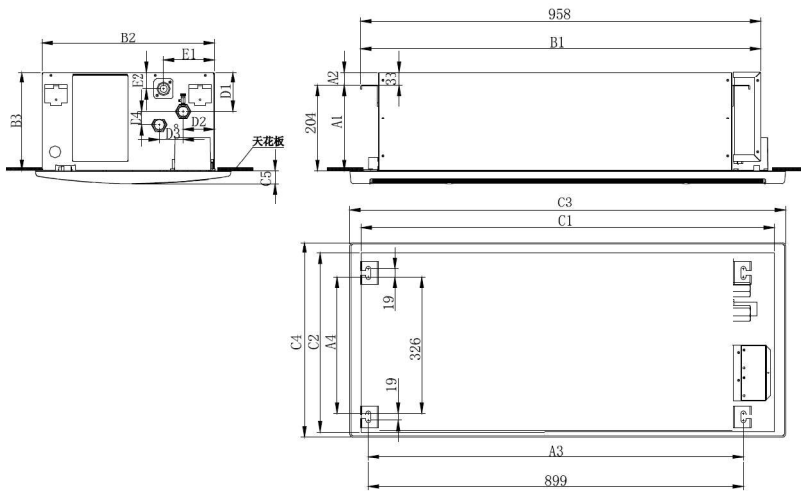

Item	Unit	VFC20C1 VFC30C1 VFC40C1 VFC50C1
A1	mm	205-210
A2	mm	31
A3	mm	899
A4	mm	326
B1	mm	958
B2	mm	413
B3	mm	236
C1	mm	990
C2	mm	426
C3	mm	1044
C4	mm	468
C5	mm	31
D1	mm	94
D2	mm	74
D3	mm	57
D4	mm	34
E1	mm	122
E2	mm	41

Right style

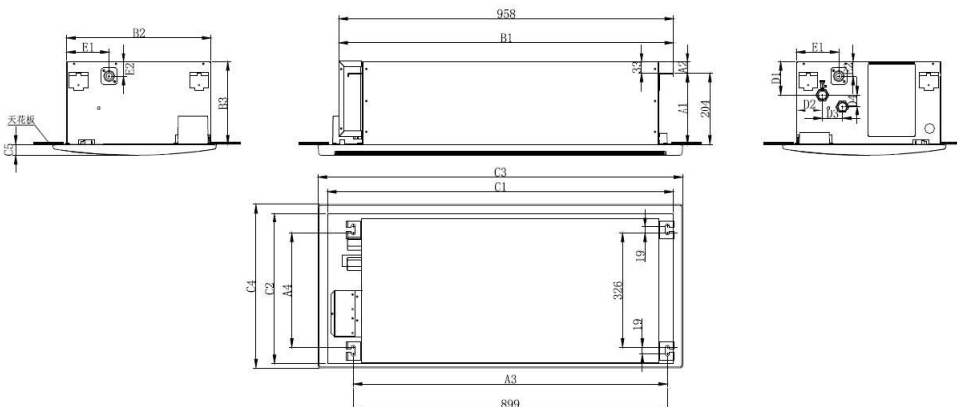

Item	Unit	VFC20C1 VFC30C1 VFC40C1 VFC50C1
A1	mm	205-210
A2	mm	31
A3	mm	899
A4	mm	326
B1	mm	958
B2	mm	413
B3	mm	236
C1	mm	990
C2	mm	426
C3	mm	1044
C4	mm	468
C5	mm	31
D1	mm	80
D2	mm	116
D3	mm	26
D4	mm	61
E1	mm	122
E2	mm	41

Dati tecnici e prestazioni

Performance Technical Data

1. Unità con 1 batteria (sistema a 2-tubi) 1. Units with 1 coil (2-pipe system)

Model			VFC20C1D2	VFC30C1D2	VFC40C1D2	VFC50C1D2	
Power supply			220V/50Hz/1Ph & 220V/60Hz/1Ph				
Air volume	H	m ³ /h	340	510	680	850	
		CFM	200	300	400	500	
	M	m ³ /h	280	380	515	660	
	L	m ³ /h	180	260	340	430	
Static pressure			Pa	0	0	0	
Cooling capacity	TH	H	W	1800	2700	3600	
			SH	W	1300	1970	2700
	TH	M	W	1500	2460	3000	
			SH	W	1000	1555	1995
	TH	L	W	1390	2057	2479	
			SH	W	823	1200	1530
Heating capacity	H	W	2700	4050	5400	6750	
		M	W	1950	2770	3935	4900
		L	W	1290	1774	2800	3505
Noise	High speed	dB(A)	37	39	41	43	
Power input	High speed	W	37	52	62	76	
Water flow	High speed	m ³ /h	0.31	0.46	0.62	0.77	
Pressure dropping			kPa	10.8	10.8	20	
Water inlet pipe diameter			ZG3/4"	ZG3/4"	ZG3/4"	ZG3/4"	
Water outlet pipe diameter			ZG3/4"	ZG3/4"	ZG3/4"	ZG3/4"	
Max working pressure			MPa	1.6	1.6	1.6	
Condensate water pipe			mm	26	26	26	
Net dimension	Unit	mm	958*413*236	958*413*236	958*413*236	958*413*236	
	Panel	mm	1044*468*31				
Net weight	Unit	kgs	22	22	23	23	
	Panel	kgs	4				

2. Unità con 2 batterie (sistema a 4-tubi) 2. Units with 2 coils (4-pipe system)

Model			VFC20C1D4	VFC30C1D4	VFC40C1D4	VFC50C1D4	
Power supply			220V/50Hz/1Ph & 220V/60Hz/1Ph				
Air volume	H	m ³ /h	340	510	680	850	
		CFM	200	300	400	500	
	M	m ³ /h	280	380	515	660	
	L	m ³ /h	180	260	340	430	
Static pressure			Pa	0	0	0	
Cooling capacity	TH	H	W	1350	2030	2700	
			SH	W	1000	1520	2080
	TH	M	W	1130	1850	2250	
			SH	W	770	1200	1540
	TH	L	W	1040	1540	1860	
			SH	W	630	920	1180
Heating capacity	H	W	1080	1620	2160	2700	
		M	W	780	1108	1574	1960
		L	W	516	710	1120	1402
Noise	High speed	dB(A)	37	39	41	43	
Power input	High speed	W	37	52	62	76	
Water flow	Cooling	m ³ /h	0.23	0.35	0.46	0.58	
	Heating	m ³ /h	0.09	0.14	0.19	0.23	
Pressure dropping	Cooling	kPa	7	7.3	13	14.6	
	Heating	kPa	4.2	4.4	7.5	8.7	
Water inlet pipe diameter			ZG3/4"	ZG3/4"	ZG3/4"	ZG3/4"	
Water outlet pipe diameter			ZG1/2"	ZG1/2"	ZG1/2"	ZG1/2"	
Max working pressure			MPa	1.6	1.6	1.6	
Condensate water pipe			mm	26	26	26	
Net dimension	Unit	mm	958*413*236	958*413*236	958*413*236	958*413*236	
	Panel	mm	1044*468*31				
Net weight	Unit	kgs	22	22	23	23	
	Panel	kgs	4				

Four-way cassette type fan coil



- With remote controller, optional wiring controller;
- Auto swing;
- With high head drain pump;
- Float switch inside to prevent from leaking;
- Optional fresh air function;
- Optional grill to prevent hurting hands;
- Optional inside water valve
- Optional MODBUS protocol.

Dimensioni Dimension

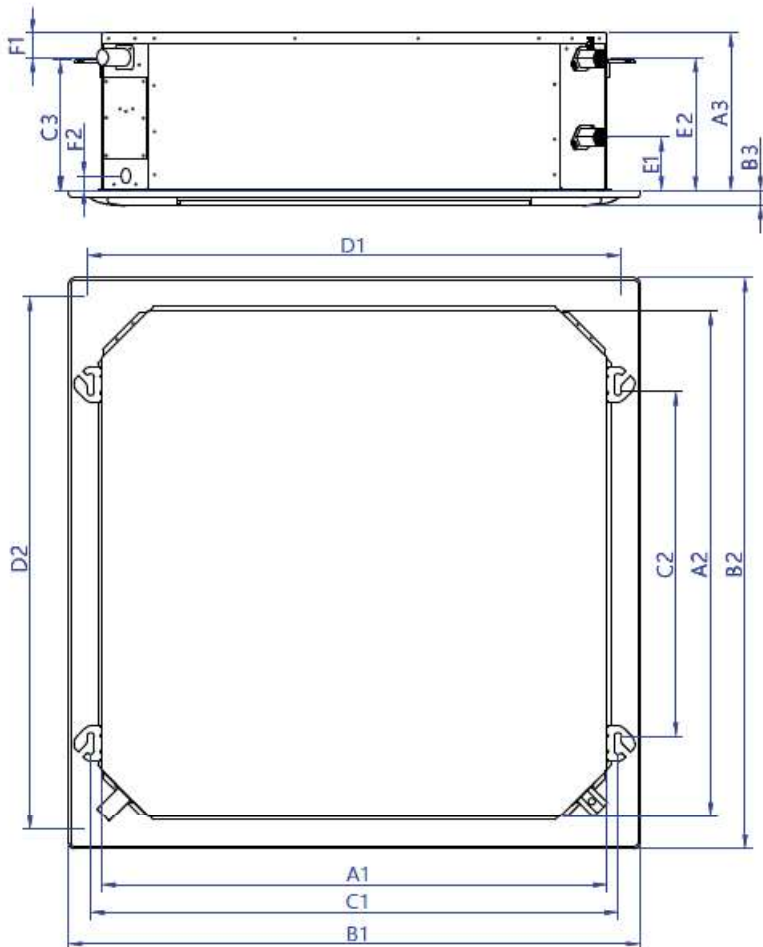

Item	Unit	VFC20C4 VFC30C4 VFC40C4	VFC50C4 VFC60C4 VFC80C4	VFC100C4 VFC120C4 VFC140C4 VFC160C4
A1	mm	570	730	930
A2	mm	570	730	930
A3	mm	290	290	290
B1	mm	650	850	1050
B2	mm	650	850	1050
B3	mm	28	28	28
C1	mm	611	769	969
C2	mm	275	433	633
C3	mm	51	51	51
D1	mm	620	810	1010
D2	mm	620	810	1010
E1	mm	98	98	98
E2	mm	242	242	242
F1	mm	242	242	242
F2	mm	26	26	26

Dati tecnici e prestazioni

Performance Technical Data

1. Unità con 1 batteria (sistema a 2-tubi) 1. Units with 1 coil (2-pipe system)

Model			VFC20C4D2	VFC30C4D2	VFC40C4D2	VFC50C4D2	VFC60C4D2	VFC80C4D2	VFC100C4D2	VFC120C4D2	VFC140C4D2	VFC160C4D2	
Power supply			220V/50Hz/1Ph Et 220V/60Hz/1Ph										
Air volume	H	m³/h	340	510	680	850	1020	1360	1700	2040	2380	2720	
		CFM	200	300	400	500	600	800	1000	1200	1400	1600	
	M	m³/h	290	400	540	700	850	1100	1400	1670	1950	2150	
		L	m³/h	200	290	400	550	680	860	1100	1300	1520	1600
Static pressure			Pa	0	0	0	0	0	0	0	0	0	
Cooling capacity	TH	H	W	1800	2700	3600	4500	5400	7200	9000	10800	12600	14400
			W	1365	2100	2790	3365	4085	5702	6780	8240	9320	11400
	SH	M	W	1555	2341	3080	3811	4510	6187	7600	9221	10513	12350
			W	1092	1680	2186	2604	3130	4300	5301	6490	7300	8500
	TH	L	W	1376	2059	2700	3362	4040	5515	6733	8230	9390	11000
			W	883	1316	1743	2117	2532	3485	4314	5314	5857	6900
Heating capacity	H	W	2700	4050	5400	6750	8100	10800	13500	16200	18900	21600	
		M	W	2187	3210	4375	5435	6550	8691	11000	13259	15300	17500
		L	W	1896	2812	3751	4673	5570	7413	9319	11312	12890	15000
Noise	High speed	dB(A)	37	39	41	43	45	46	48	50	51	53	
Power input	High speed	W	37	52	62	76	96	134	152	189	228	250	
Water flow	High speed	m³/h	0.31	0.46	0.62	0.77	0.93	1.23	1.54	1.85	2.16	2.46	
Pressure dropping		kPa	11.8	12.9	22.1	18.2	26.8	28.4	33.2	35.9	38.4	40	
Water inlet pipe diameter			ZG3/4"	ZG3/4"	ZG3/4"	ZG3/4"	ZG3/4"	ZG3/4"	ZG3/4"	ZG3/4"	ZG3/4"	ZG3/4"	
Water outlet pipe diameter			ZG3/4"	ZG3/4"	ZG3/4"	ZG3/4"	ZG3/4"	ZG3/4"	ZG3/4"	ZG3/4"	ZG3/4"	ZG3/4"	
Max working pressure		MPa	1.6	1.6	1.6	1.6	1.6	1.6	1.6	1.6	1.6	1.6	
Condensate water pipe		mm	26	26	26	26	26	26	26	26	26	26	
Net dimension	Unit	mm	570*570*290				730*730*290			930*930*290			
	Panel	mm	650*650*45				850*850*45			1050*1050*45			
Net weight	Unit	kgs	17.6	17.6	20	25	26	26	35	36	36	37	

2. Unità con 2 batterie (sistema a 4-tubi) 2. Units with 2 coils (4-pipe system)

Model			VFC20C4D4	VFC30C4D4	VFC40C4D4	VFC50C4D4	VFC60C4D4	VFC80C4D4	VFC100C4D4	VFC120C4D4	VFC140C4D4	VFC160C4D4	
Power supply			220V/50Hz/1Ph Et 220V/60Hz/1Ph										
Air volume	H	m³/h	340	510	680	850	1020	1360	1700	2040	2380	2720	
		CFM	200	300	400	500	600	800	1000	1200	1400	1600	
	M	m³/h	290	400	540	700	850	1100	1400	1670	1950	2150	
		L	m³/h	200	290	400	550	680	860	1100	1300	1520	1600
Static pressure			Pa	0	0	0	0	0	0	0	0	0	
Cooling capacity	TH	H	W	1400	2100	2800	3500	4200	5600	7000	8400	9850	11200
			W	1050	1570	2098	2650	3217	4200	5250	6300	7350	8400
	SH	M	W	1200	1793	2342	2989	3570	4760	5950	7140	8355	9520
			W	850	1262	1619	2100	2499	3332	4165	4998	5850	6664
	TH	L	W	1060	1571	2110	2612	3150	4200	5250	6300	7347	8400
			W	675	1000	1340	1643	1998	2667	3333	4009	4663	5334
Heating capacity	H	W	1080	1620	2160	2700	3240	4320	5400	6480	7200	8640	
		M	W	870	1310	1762	2160	2620	3489	4374	5251	5832	6978
		L	W	752	1102	1497	1845	2233	2978	3726	4453	4968	5956
Noise	High speed	dB(A)	37	39	41	43	45	46	48	50	51	53	
Power input	High speed	W	37	52	62	76	96	134	152	189	228	250	
Water flow	Cooling	m³/h	0.24	0.36	0.48	0.60	0.72	0.96	1.21	1.45	1.70	1.98	
	Heating	m³/h	0.09	0.14	0.18	0.23	0.27	0.36	0.45	0.54	0.60	0.72	
Pressure dropping		kPa	8.22	8.54	12.88	16.45	21.07	22.15	25.32	26.67	29.44	31.05	
		kPa	3.51	3.84	6.31	7.37	8.26	8.56	10.87	11.65	12.31	12.78	
Water inlet pipe diameter			ZG3/4"	ZG3/4"	ZG3/4"	ZG3/4"	ZG3/4"	ZG3/4"	ZG3/4"	ZG3/4"	ZG3/4"	ZG3/4"	
Water outlet pipe diameter			ZG3/4"	ZG3/4"	ZG3/4"	ZG3/4"	ZG3/4"	ZG3/4"	ZG3/4"	ZG3/4"	ZG3/4"	ZG3/4"	
Max working pressure		MPa	1.6	1.6	1.6	1.6	1.6	1.6	1.6	1.6	1.6	1.6	
Condensate water pipe		mm	26	26	26	26	26	26	26	26	26	26	
Net dimension	Unit	mm	570*570*290				730*730*290			930*930*290			
	Panel	mm	650*650*45				850*850*45			1050*1050*45			
Net weight	U+P	kgs	20	20	21	26	26	26	37	37	38	38	

Surround cassette type fan coil



- With remote controller, optional wiring controller;
- Auto swing;
- With high head drain pump;
- Float switch inside to prevent from leaking;
- Optional fresh air function;
- Optional grill to prevent hurting hands;
- Optional inside water valve
- Optional MODBUS protocol.

Dimensioni Dimension

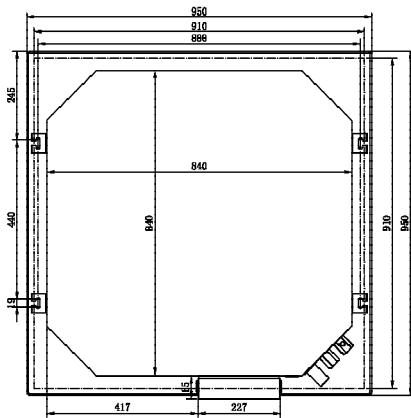
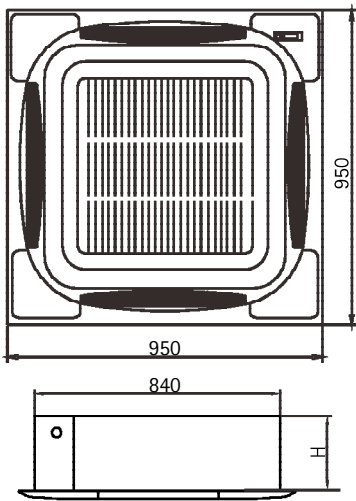

Model	VFC60C8 VFC80C8	VFC100C8 VFC120C8 VFC140C8
Height (mm)	242	292

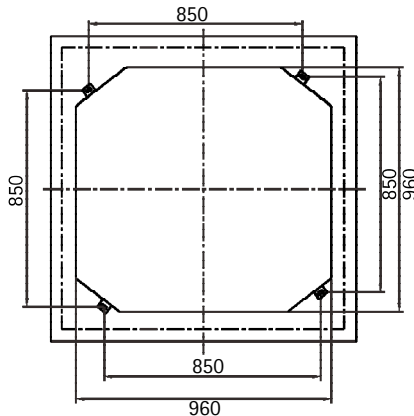
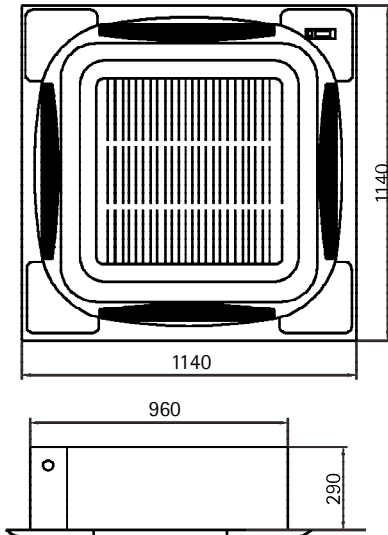
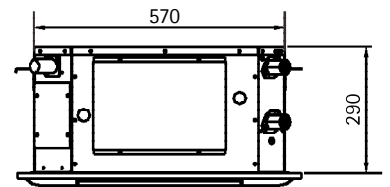
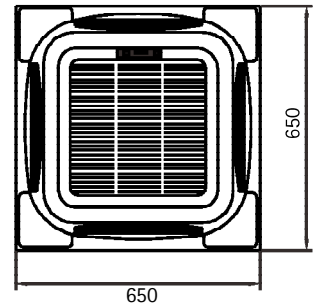

VFC160C8

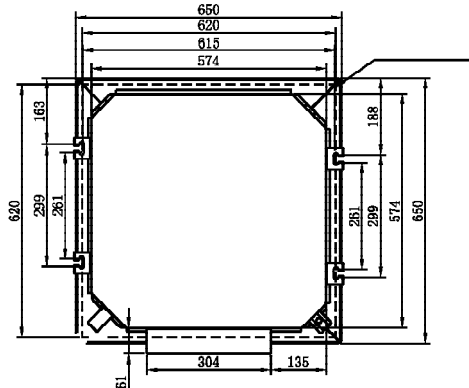

VFC20C8
VFC30C8
VFC40C8
VFC50C8

Dati tecnici e prestazioni

Performance Technical Data

1. Unità con 1 batteria (sistema a 2-tubi) 1. Units with 1 coil (2-pipe system)

Model	VFC20C8D2	VFC30C8D2	VFC40C8D2	VFC50C8D2	VFC60C8D2	VFC80C8D2	VFC100C8D2	VFC120C8D2	VFC140C8D2	VFC160C8D2			
Power supply	220V/50Hz/1Ph Et 220V/60Hz/1Ph												
Air volume	H	m³/h	340	510	680	850	1020	1360	1700	2040	2380	2720	
		CFM	200	300	400	500	600	800	1000	1200	1400	1600	
	M	m³/h	280	380	515	660	765	1040	1280	1550	1800	2300	
		L	m³/h	180	260	340	430	530	710	860	1050	1280	1730
Static pressure		Pa	0	0	0	0	0	0	0	0	0		
Cooling capacity	TH	H	W	1800	2700	3600	4500	5400	7200	9000	10800	12600	14400
			SH	W	1311	1971	2700	3184	4196	5362	6707	8072	9070
	TH	M	W	1500	2460	3000	3715	4423	6435	7848	9296	10500	12968
			SH	W	994	1555	1995	2426	3041	4236	5393	6603	7190
	TH	L	W	1391	2057	2479	2921	3793	5604	7223	8534	8900	11550
			SH	W	823	1200	1530	1826	2373	3284	4416	5248	5500
Heating capacity	H	W	2700	4050	5400	6750	8100	10800	13500	16200	18900	21600	
		M	W	1949	2770	3938	4902	5694	7924	10473	12997	13900	18375
		L	W	1297	1774	2779	3505	3876	5421	6992	8645	9700	15750
Noise	High speed	dB(A)	37	39	41	43	45	46	48	50	51	53	
Power input	High speed	W	37	52	62	76	96	134	152	189	228	250	
Water flow	High speed	m³/h	0.31	0.46	0.62	0.77	0.93	1.23	1.54	1.85	2.16	2.46	
Pressure dropping		kPa	16	18	22.4	27	29.6	29.6	35.4	35.4	40	40	
Water inlet pipe diameter			ZG3/4"	ZG3/4"	ZG3/4"	ZG3/4"	ZG3/4"	ZG3/4"	ZG3/4"	ZG3/4"	ZG3/4"	ZG3/4"	
Water outlet pipe diameter			ZG3/4"	ZG3/4"	ZG3/4"	ZG3/4"	ZG3/4"	ZG3/4"	ZG3/4"	ZG3/4"	ZG3/4"	ZG3/4"	
Max working pressure		MPa	1.6	1.6	1.6	1.6	1.6	1.6	1.6	1.6	1.6	1.6	
Condensate water pipe		mm	26	26	26	26	26	26	26	26	26	26	
Net dimension	Unit	mm	570*570*290				840*840*242		840*840*292		960*960*290		
	Panel	mm	650*650*30				950*950*45				1140*1140*45		
Net weight	U+P	kgs	19+2	19+2	20+2	21+2	24+6	25+6	28+6	28+6	30+6	36+8	

2. Unità con 2 batterie (sistema a 4-tubi) 2. Units with 2 coils (4-pipe system)

Model	VFC20C8D4	VFC30C8D4	VFC40C8D4	VFC50C8D4	VFC60C8D4	VFC80C8D4	VFC100C8D4	VFC120C8D4	VFC140C8D4	VFC160C8D4			
Power supply	220V/50Hz/1Ph Et 220V/60Hz/1Ph												
Air volume	H	m³/h	340	510	680	850	1020	1360	1700	2040	2380	2720	
		CFM	200	300	400	500	600	800	1000	1200	1400	1600	
	M	m³/h	280	380	515	660	765	1040	1280	1550	1800	2300	
		L	m³/h	180	260	340	430	530	710	860	1050	1280	1730
Static pressure		Pa	0	0	0	0	0	0	0	0	0		
Cooling capacity	TH	H	W	1350	2030	2700	3380	4050	5400	6750	8100	9450	11760
			SH	W	1010	1520	2080	2450	3230	4130	5160	6220	6989
	TH	M	W	1130	1850	2250	2790	3320	4830	5890	6970	7873	9996
			SH	W	770	1200	1540	1870	2340	3260	4150	5080	5532
	TH	L	W	1040	1540	1860	2190	2840	4200	5420	6400	6674	8825
			SH	W	630	920	1180	1410	1830	2530	3400	4040	4234
Heating capacity	H	W	1080	1620	2160	2700	3240	4320	5400	6480	7560	9070	
		M	W	780	1108	1575	1961	2278	3170	4189	5199	5560	7330
		L	W	519	710	1112	1402	1550	2168	2797	3458	3880	6250
Noise	High speed	dB(A)	37	39	41	43	45	46	48	50	51	53	
Power input	High speed	W	37	52	62	76	96	134	152	189	228	250	
Water flow	Cooling	m³/h	0.23	0.35	0.46	0.58	0.69	0.93	1.16	1.39	1.60	1.98	
	Heating	m³/h	0.09	0.14	0.19	0.23	0.28	0.37	0.46	0.56	0.70	0.74	
Pressure dropping		kPa	8.26	8.26	15.68	18.9	20.72	20.72	24.78	24.78	40	42	
		kPa	3.54	3.54	6.72	8.1	8.88	8.88	10.62	10.62	16	18	
Water inlet pipe diameter			ZG3/4"	ZG3/4"	ZG3/4"	ZG3/4"	ZG3/4"	ZG3/4"	ZG3/4"	ZG3/4"	ZG3/4"	ZG3/4"	
Water outlet pipe diameter			ZG3/4"	ZG3/4"	ZG3/4"	ZG3/4"	ZG3/4"	ZG3/4"	ZG3/4"	ZG3/4"	ZG3/4"	ZG3/4"	
Max working pressure		MPa	1.6	1.6	1.6	1.6	1.6	1.6	1.6	1.6	1.6	1.6	
Condensate water pipe		mm	26	26	26	26	26	26	26	26	26	26	
Net dimension	Unit	mm	570*570*290				840*840*242		840*840*292		960*960*290		
	Panel	mm	650*650*30				950*950*45				1140*1140*45		
Net weight	U+P	kgs	19+2	19+2	20+2	21+2	24+6	25+6	28+6	28+6	30+6	36+8	

Ceiling Floor Type Fan Coil



Classical design;
 Flexible ceiling/floor standing/wall mounted;
 With remote controller, optional wiring controller;
 Auto swing;
 Optional inside water valve
 Optional MODBUS protocol.

Dimensioni Dimension

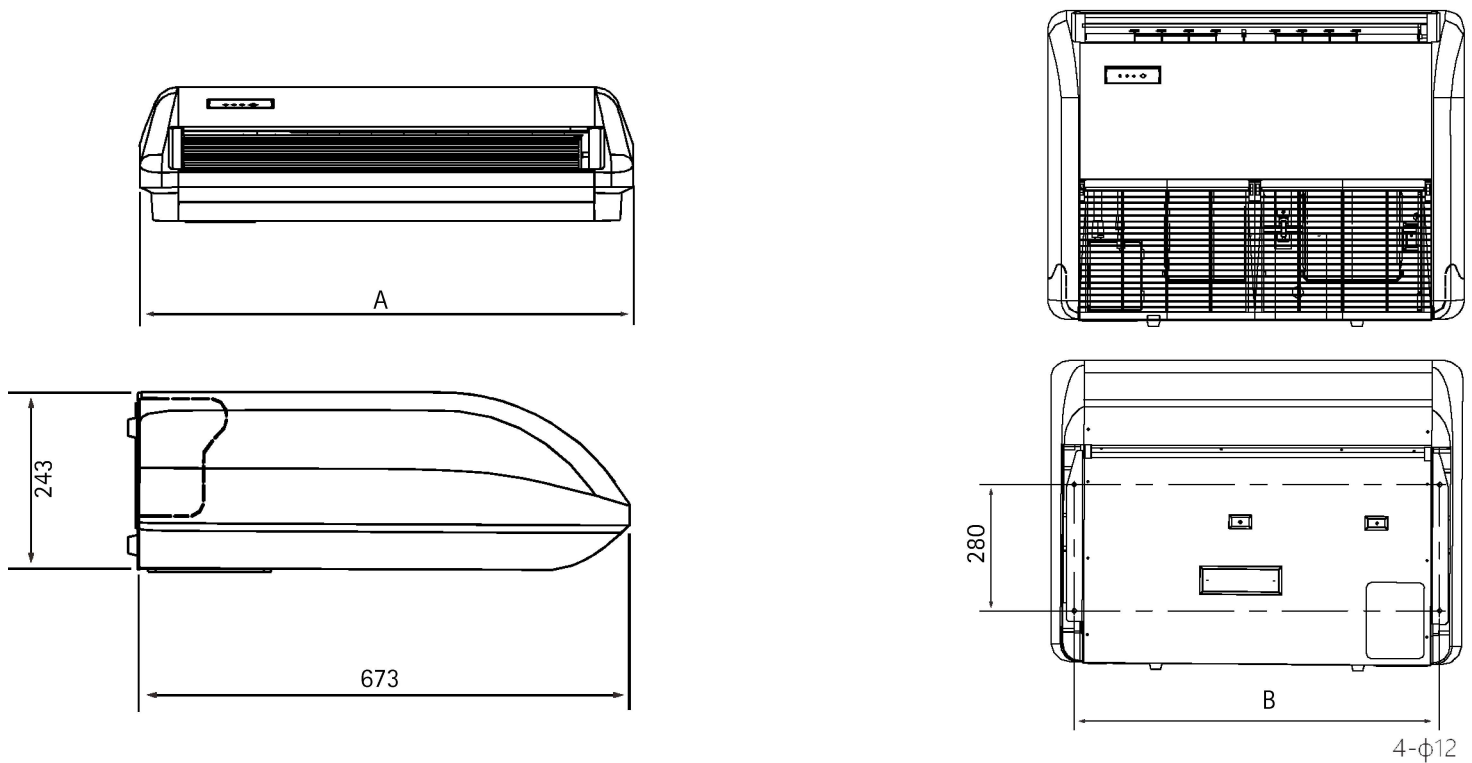

Model	VFC30CF VFC40CF VFC50CF	VFC60CF VFC80CF	VFC100CF VFC120CF VFC140CF
A (mm)	905	1288	1672
B (mm)	801	1184	1568

Dati tecnici e prestazioni

Performance Technical Data

1. Unità con 1 batteria (sistema a 2-tubi) 1. Units with 1 coil (2-pipes system)

Model			VFC30CFD2	VFC40CFD2	VFC50CFD2	VFC60CFD2	VFC80CFD2	VFC100CFD2	VFC120CFD2	VFC140CFD2	
Power supply			220V/50Hz/1Ph Et 220V/60Hz/1Ph								
Air volume	H	m ³ /h	510	680	850	1020	1360	1700	2040	2380	
		CFM	300	400	500	600	800	1000	1200	1400	
	M	m ³ /h	380	515	660	765	1040	1280	1550	1800	
		L	m ³ /h	260	340	430	530	710	860	1050	1280
Static pressure			Pa	0	0	0	0	0	0	0	
Cooling capacity	TH	H	W	2700	3600	4500	5400	7200	9000	10800	12600
			W	1990	2730	3174	4261	5385	6746	8109	9062
	SH	M	W	2485	3030	3752	4467	6499	7926	9389	10605
			W	1571	2015	2450	3071	4278	5447	6669	7262
	TH	L	W	2078	2504	2950	3831	5660	7295	8619	8989
			W	1212	1545	1844	2397	3317	4460	5300	5555
Heating capacity	H	W	4050	5400	6750	8100	10800	13500	16200	18900	
		W	2792	3970	4941	5740	7987	10557	13101	14011	
		W	1788	2801	3533	3907	5464	7048	8714	9778	
Noise	High speed	dB(A)	39	41	43	45	46	48	50	51	
Power input	High speed	W	52	62	76	96	134	152	189	228	
Water flow	High speed	m ³ /h	0.46	0.62	0.77	0.93	1.23	1.54	1.85	2.16	
Pressure dropping			kPa	16	18	21	23	25	32	33	38
Water inlet pipe diameter				ZG3/4"	ZG3/4"	ZG3/4"	ZG3/4"	ZG3/4"	ZG3/4"	ZG3/4"	
Water outlet pipe diameter				ZG3/4"	ZG3/4"	ZG3/4"	ZG3/4"	ZG3/4"	ZG3/4"	ZG3/4"	
Max working pressure			MPa	1.6	1.6	1.6	1.6	1.6	1.6	1.6	
Condensate water pipe			mm	26	26	26	26	26	26	26	
Net dimension			mm	905*673*243			1288*673*243		1672*673*243		
Net weight			kgs	26	28	30	38	40	42	45	

2. Unità con 2 batterie (sistema a 4-tubi) 2. Units with 2 coils (4-pipe system)

Model			VFC30CFD4	VFC40CFD4	VFC50CFD4	VFC60CFD4	VFC80CFD4	VFC100CFD4	VFC120CFD4	VFC140CFD4	
Power supply			220V/50Hz/1Ph Et 220V/60Hz/1Ph								
Air volume	H	m ³ /h	510	680	850	1020	1360	1700	2040	2380	
		CFM	300	400	500	600	800	1000	1200	1400	
	M	m ³ /h	380	515	660	765	1040	1280	1550	1800	
		L	m ³ /h	260	340	430	530	710	860	1050	1280
Static pressure			Pa	0	0	0	0	0	0	0	
Cooling capacity	TH	H	W	2025	2700	3375	4050	5400	6750	8100	9450
			W	1532	2102	2444	3281	4146	5194	6244	6978
	SH	M	W	1864	2273	2814	3350	4874	5945	7042	7954
			W	1210	1552	1887	2365	3294	4194	5135	5592
	TH	L	W	1559	1878	2213	2873	4245	5471	6464	6742
			W	933	1190	1420	1846	2554	3434	4081	4277
Heating capacity	H	W	1620	2160	2700	3240	4320	5400	6480	7560	
		W	1117	1588	1976	2296	3195	4223	5240	5604	
		W	715	1120	1413	1563	2186	2819	3486	3911	
Noise	High speed	dB(A)	39	41	43	45	46	48	50	51	
Power input	High speed	W	52	62	76	96	134	152	189	228	
Water flow	Cooling	m ³ /h	0.34	0.45	0.56	0.67	0.89	1.11	1.33	1.55	
	Heating	m ³ /h	0.14	0.19	0.24	0.29	0.39	0.49	0.59	0.69	
Pressure dropping			kPa	8.4	9.7	14.9	16.3	17.8	22.7	23.4	27
			kPa	3.5	4.1	6.3	6.9	7.5	9.6	9.9	11.4
Water inlet pipe diameter				ZG3/4"	ZG3/4"	ZG3/4"	ZG3/4"	ZG3/4"	ZG3/4"	ZG3/4"	
Water outlet pipe diameter				ZG3/4"	ZG3/4"	ZG3/4"	ZG3/4"	ZG3/4"	ZG3/4"	ZG3/4"	
Max working pressure			MPa	1.6	1.6	1.6	1.6	1.6	1.6	1.6	
Condensate water pipe			mm	26	26	26	26	26	26	26	
Net dimension			mm	905*673*243			1288*673*243		1672*673*243		
Net weight			kgs	27	29	31	39	41	43	46	

High Wall Mounted Type Fan Coil



Inside digital display panel;
Remote controller;
Optional stainless steel connector.

Dati tecnici e prestazioni Performance Technical Data

Model			VFC20HWD2	VFC30HWD2	VFC40HWD2	VFC50HWD2	VFC60HWD2	VFC80HWD2	
Power supply			220V/50Hz/1Ph Et 220V/60Hz/1Ph						
Air volume	H	m ³ /h	340	510	680	850	1020	1360	
		CFM	200	300	400	500	600	800	
	M	m ³ /h	260	380	515	660	765	1010	
		L	m ³ /h	180	260	340	430	520	700
Static pressure			Pa	0	0	0	0	0	
Cooling capacity	TH	H	W	1800	2700	3600	4500	5400	7200
		SH	W	1350	2025	2700	3375	4050	5400
	M	TH	W	1476	2214	2952	3690	4428	5904
		SH	W	978	1399	1963	2409	3044	3926
	L	TH	W	1098	1647	2196	2745	3294	4392
		SH	W	649	960	1355	1715	2060	2710
Heating capacity	H	W	2700	4050	5400	6750	8100	10800	
	M	W	2164	3219	4293	5366	6439	8586	
	L	W	1512	2268	3024	3780	4536	6048	
Noise	High speed	dB(A)	37	39	41	43	45	46	
Power input	High speed	W	30	38	45	50	90	100	
Water flow	High speed	m ³ /h	0.31	0.46	0.62	0.77	0.93	0.93	
Pressure dropping			kPa	16	20	21	22.5	23.5	
Water inlet pipe diameter			ZG1/2"	ZG1/2"	ZG1/2"	ZG1/2"	ZG1/2"	ZG1/2"	
Water outlet pipe diameter			ZG1/2"	ZG1/2"	ZG1/2"	ZG1/2"	ZG1/2"	ZG1/2"	
Max working pressure			MPa	1.6	1.6	1.6	1.6	1.6	
Condensate water pipe			mm	ZG1/2"	ZG1/2"	ZG1/2"	ZG1/2"	ZG1/2"	
Net dimension			mm	850*300*198	850*300*198	970*315*235	970*315*235	1100*330*235	1100*330*235
Net weight			kgs	11.2	11.2	14.5	14.5	16.5	16.5

Duct Concealed Type Fan Coil

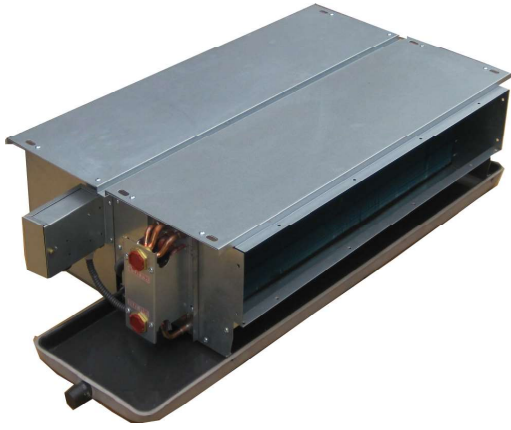

9.52mm copper tube;

Hydrophilic aluminum fins;

1.2mm & 0.8mm galvanized steel panel;

The best YONGAN motor and YILIDA fan curve;

12Pa/30Pa/50Pa static pressure for options;

Drian pan: cold plate with surface paint treatment,
0.8mm thickness, 6mm thickness of insulation;

Optional wiring controller;

Optional electrical heater;

Optional MODBUS protocol.

Dimensioni Dimension

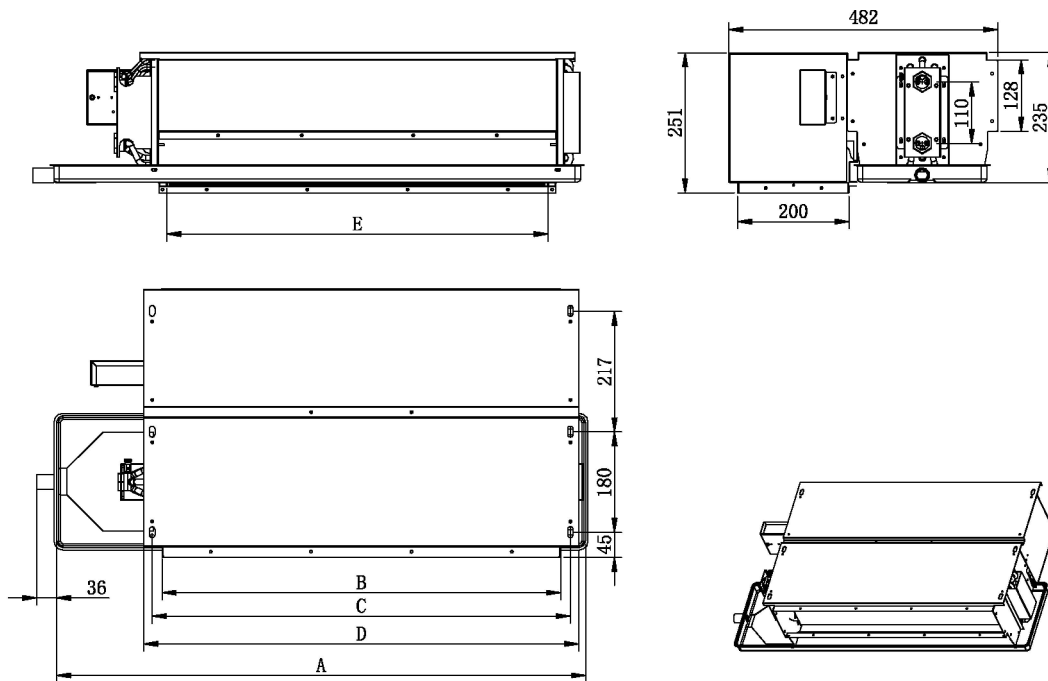

Model	VFC20DL	VFC30DL	VFC40DL	VFC50DL	VFC60DL	VFC80DL	VFC100DL	VFC120DL	VFC140DL
A (mm)	755	855	955	1080	1175	1460	1650	1915	2150
B (mm)	515	615	715	840	935	1220	1410	1675	1910
C (mm)	550	650	750	875	970	1225	1445	1710	1945
D (mm)	580	680	780	905	1000	1285	1475	1740	1975
E (mm)	485	585	685	810	905	1190	1380	1645	1880

Dati tecnici e prestazioni

Performance Technical Data

1. Unità con 1 batteria (sistema a 2-tubi) 1. Units with 1 coil (2-pipes system)

Model		VFC20DLC2	VFC30DLC2	VFC40DLC2	VFC50DLC2	VFC60DLC2	VFC80DLC2	VFC100DLC2	VFC120DLC2	VFC140DLC2		
Power supply		220V/50Hz/1Ph & 220V/60Hz/1Ph										
Air volume	H	m³/h	340	510	680	850	1020	1360	1700	2040	2380	
		CFM	200	300	400	500	600	800	1000	1200	1400	
	M	m³/h	270	380	515	660	765	1040	1280	1550	1800	
	L	m³/h	190	260	340	430	530	710	860	1050	1280	
Static pressure		Pa	12(30)(50)	12(30)(50)	12(30)(50)	12(30)(50)	12(30)(50)	12(30)(50)	12(30)(50)	12(30)(50)	12(30)(50)	
Cooling capacity	TH	H	W	1800	2700	3600	4500	5400	7200	9000	10800	12600
			SH	W	1341	2012	2682	3353	4023	5364	6705	8046
	TH	M	W	1458	2187	2916	3645	4374	5832	7290	8748	10206
			SH	W	1152	1728	2304	2880	3455	4607	5759	6911
	TH	L	W	1134	1701	2268	2835	3402	4536	5670	6804	7938
			SH	W	930	1395	1860	2325	2790	3720	4649	5579
Heating capacity	H	M	W	2700	4050	5400	6750	8100	10800	13500	16200	18900
			W	2079	3119	4158	5198	6237	8316	10395	12474	14553
	L	W	1634	2450	3267	4084	4901	6534	8168	9801	11435	
Noise (high speed)	12Pa	dB(A)	37	39	41	43	45	46	48	50	52	
	30Pa	dB(A)	39	41	43	45	48	49	50	52	54	
Power input (high speed)	12Pa	W	34	41	59	73	91	118	146	182	216	
	30Pa	W	41	54	65	82	98	132	168	206	247	
Water flow	High speed	m³/h	0.31	0.46	0.62	0.77	0.93	1.23	1.54	1.85	2.16	
Pressure dropping		kPa	16	18	20	23	28	30	33	37	40	
Water inlet pipe diameter			ZG3/4"	ZG3/4"	ZG3/4"	ZG3/4"	ZG3/4"	ZG3/4"	ZG3/4"	ZG3/4"	ZG3/4"	
Water outlet pipe diameter			ZG3/4"	ZG3/4"	ZG3/4"	ZG3/4"	ZG3/4"	ZG3/4"	ZG3/4"	ZG3/4"	ZG3/4"	
Max working pressure		MPa	1.6	1.6	1.6	1.6	1.6	1.6	1.6	1.6	1.6	
Condensate water pipe		mm	26	26	26	26	26	26	26	26	26	
Net dimension		mm	755*482*235	855*482*235	955*482*235	1080*482*235	1175*482*235	1460*482*235	1650*482*235	1915*482*235	2150*482*235	
Net weight		kgs	15.4	17.9	20	21.9	23.3	32.3	35.7	40	44.9	

2. Unità con 2 batterie (sistema a 4-tubi) 2. Units with 2 coils (4-pipe system)

Model		VFC20DLC4	VFC30DLC4	VFC40DLC4	VFC50DLC4	VFC60DLC4	VFC80DLC4	VFC100DLC4	VFC120DLC4	VFC140DLC4		
Power supply		220V/50Hz/1Ph & 220V/60Hz/1Ph										
Air volume	H	m³/h	340	510	680	850	1020	1360	1700	2040	2380	
		CFM	200	300	400	500	600	800	1000	1200	1400	
	M	m³/h	270	380	515	660	765	1040	1280	1550	1800	
	L	m³/h	190	260	340	430	530	710	860	1050	1280	
Static pressure		Pa	12(30)	12(30)	12(30)	12(30)	12(30)	12(30)	12(30)	12(30)	12(30)	
Cooling capacity	TH	H	W	1800	2700	3600	4500	5400	7200	9000	10800	12600
			SH	W	1341	2012	2682	3353	4023	5364	6705	8046
	TH	M	W	1458	2187	2916	3645	4374	5832	7290	8748	10206
			SH	W	1152	1728	2304	2880	3455	4607	5759	6911
	TH	L	W	1134	1701	2268	2835	3402	4536	5670	6804	7938
			SH	W	930	1395	1860	2325	2790	3720	4649	5579
Heating capacity	H	M	W	1080	1620	2160	2700	3240	4320	5400	6480	7560
			W	832	1248	1663	2079	2495	3326	4158	4990	5821
	L	W	654	980	1307	1634	1960	2614	3267	3920	4574	
Noise (high speed)	12Pa	dB(A)	37	39	41	43	45	46	48	50	52	
	30Pa	dB(A)	39	41	43	45	48	49	50	52	54	
Power input (high speed)	12Pa	W	34	41	59	73	91	118	146	182	216	
	30Pa	W	41	54	65	82	98	132	168	206	247	
Water flow	Cooling	m³/h	0.31	0.46	0.62	0.77	0.93	1.23	1.54	1.85	2.16	
	Heating	m³/h	0.12	0.18	0.25	0.31	0.37	0.49	0.62	0.74	0.86	
Pressure dropping		kPa	16	18	20	23	28	30	33	37	40	
		kPa	8	10	12	14	16	20	22	25	28	
Water inlet pipe diameter			ZG3/4"	ZG3/4"	ZG3/4"	ZG3/4"	ZG3/4"	ZG3/4"	ZG3/4"	ZG3/4"	ZG3/4"	
Water outlet pipe diameter			ZG3/4"	ZG3/4"	ZG3/4"	ZG3/4"	ZG3/4"	ZG3/4"	ZG3/4"	ZG3/4"	ZG3/4"	
Max working pressure		MPa	1.6	1.6	1.6	1.6	1.6	1.6	1.6	1.6	1.6	
Condensate water pipe		mm	26	26	26	26	26	26	26	26	26	
Net dimension		mm	755*482*235	855*482*235	955*482*235	1080*482*235	1175*482*235	1460*482*235	1650*482*235	1915*482*235	2150*482*235	
Net weight		mm	17	19.4	21.5	23.7	25	34.5	38	43	48	

Dati tecnici e prestazioni

Performance Technical Data

3. Unità con 1 batteria (4-Ranghi) 1. Units with 1 coil (4 rows)

Model		VFC20DL4C2	VFC30DL4C2	VFC40DL4C2	VFC50DL4C2	VFC60DL4C2	VFC80DL4C2	VFC100DL4C2	VFC120DL4C2	VFC140DL4C2			
Power supply		220V/50Hz/1Ph											
Air volume	H	m ³ /h	340	510	680	850	1020	1360	1700	2040	2380		
		CFM	200	300	400	500	600	800	1000	1200	1400		
	M	m ³ /h	270	380	515	660	765	1040	1280	1550	1800		
	L	m ³ /h	190	260	340	430	530	710	860	1050	1280		
Static pressure		Pa	12(30)	12(30)	12(30)	12(30)	12(30)	12(30)	12(30)	12(30)	12(30)		
Cooling capacity	TH	H	W	2000	2950	3950	4950	5950	7900	9900	11900	13850	
			SH	W	1375	2062	2749	3437	4124	5498	6873	8247	9622
	TH	M	W	1560	2340	3120	3900	4680	6240	7800	9360	10920	
			SH	W	1232	1849	2465	3081	3697	4930	6162	7394	8627
	TH	L	W	1213	1820	2427	3033	3640	2854	6067	7280	8494	
			SH	W	995	1492	1990	2487	2985	3980	4975	5970	6965
Heating capacity	H	W	W	2950	4450	5950	7450	8900	11900	14850	17800	20800	
			M	W	2256	3383	4511	5639	6768	9023	11279	13534	15790
			L	W	1773	2658	3545	4431	5317	7089	8862	10634	12407
Noise (high speed)	12Pa	dB(A)	37	39	41	43	45	46	48	50	52		
	30Pa	dB(A)	39	41	43	45	48	49	50	52	54		
Power input (high speed)	12Pa	W	44	59	72	87	108	156	174	212	253		
	30Pa	W	49	66	84	100	118	174	210	250	300		
Water flow	High speed	m ³ /h	0.33	0.49	0.66	0.82	1.00	1.32	1.65	1.98	2.31		
Pressure dropping		kPa	8	17	20	25	31	33	24	33	40		
Water inlet pipe diameter			ZG3/4"	ZG3/4"	ZG3/4"	ZG3/4"	ZG3/4"	ZG3/4"	ZG3/4"	ZG3/4"	ZG3/4"		
Water outlet pipe diameter			ZG3/4"	ZG3/4"	ZG3/4"	ZG3/4"	ZG3/4"	ZG3/4"	ZG3/4"	ZG3/4"	ZG3/4"		
Max working pressure		MPa	1.6	1.6	1.6	1.6	1.6	1.6	1.6	1.6	1.6		
Condensate water pipe		mm	26	26	26	26	26	26	26	26	26		
Net dimension		mm	755*482*235	855*482*235	955*482*235	1080*482*235	1175*482*235	1460*482*235	1650*482*235	1915*482*235	2150*482*235		
Net weight		kgs	17	19	21	23	26	34	37	41	47		

Duct High Static Pressure type Fan Coil



- 120Pa high static pressure;
- Low noise;
- Optional wiring controller;
- Optional electrical heater;
- Optional MODBUS protocol.

Dimensioni Dimension

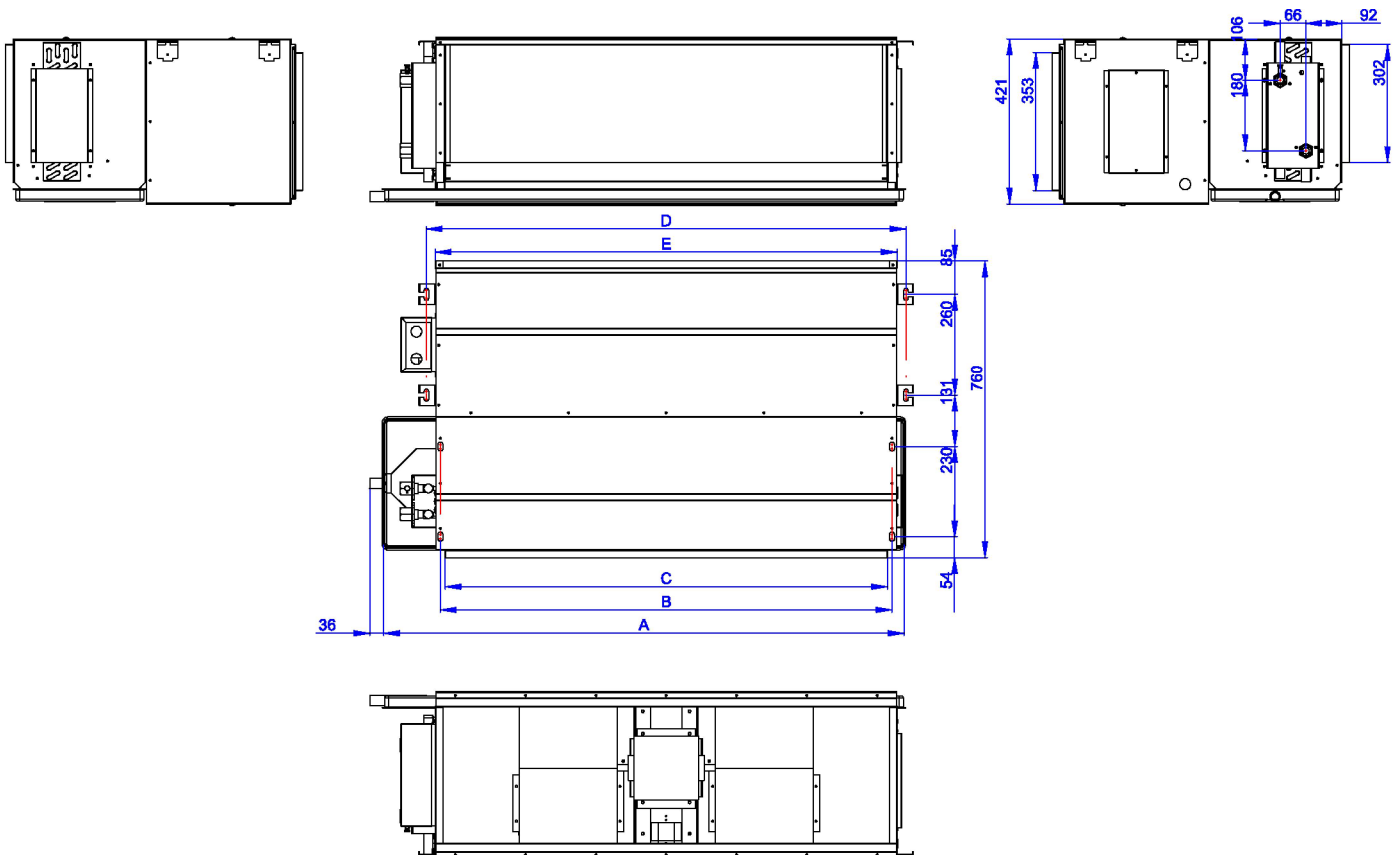

Model	VFC80DH	VFC100DH	VFC120DH	VFC140DH	VFC160DH	VFC180DH	VFC200DH	VFC240DH
A (mm)	930	1010	1010	1150	1150	1340	1340	1600
B (mm)	746	826	826	966	966	1156	1156	1416
C (mm)	722	802	802	942	942	1132	1132	1392
D (mm)	818	898	898	1038	1038	1228	1228	1488
E (mm)	772	852	852	992	992	1182	1182	1442

Dati tecnici e prestazioni

Performance Technical Data

1. Unità con 1 batteria (sistema a 2-tubi) 1. Units with 1 coil (2-pipes system)



Model			VFC80DHC2	VFC100DHC2	VFC120DHC2	VFC140DHC2	VFC160DHC2	VFC180DHC2	VFC200DHC2	VFC240DHC2	
Power supply			220V/50Hz/1Ph Et 220V/60Hz/1Ph								
Air volume	H	m ³ /h	1360	1700	2040	2380	2720	3060	3400	4080	
		CFM	800	1000	1200	1400	1600	1800	2000	2400	
	M	m ³ /h	1090	1360	1635	1900	2180	2450	2720	3260	
		L	m ³ /h	815	1020	1225	1430	1630	1830	2040	2450
Static pressure			Pa	120	120	120	120	120	120	120	
Cooling capacity	TH	H	W	7200	9000	10800	12600	14400	16200	18000	21600
			SH	W	5350	6650	8000	9350	10650	12000	13350
	TH	M	W	5450	6800	8150	9500	10850	12250	13600	16300
			SH	W	3900	4900	5850	6850	7800	8800	9800
	TH	L	W	4200	5250	6300	7350	8400	9450	10500	12600
			SH	W	2950	3700	4450	5200	5950	6650	7400
Heating capacity	H	W	10800	13500	16200	18900	21600	24300	27000	32400	
		M	W	8200	10250	12300	14350	16400	18450	20500	24600
	L	W	7000	8800	10550	12300	14050	15800	17550	21050	
Noise (high speed)			dB(A)	51	51	52	54	54	56	56	57
Power input (high speed)			W	380	420	450	520	550	880	900	1100
Water flow	High speed	m ³ /h		1.23	1.54	1.85	2.16	2.46	2.77	3.08	3.70
Pressure dropping			kPa	25	28	30	35	36	42	43	50
Water inlet pipe diameter				ZG3/4"	ZG3/4"	ZG3/4"	ZG3/4"	ZG3/4"	ZG3/4"	ZG3/4"	ZG3/4"
Water outlet pipe diameter				ZG3/4"	ZG3/4"	ZG3/4"	ZG3/4"	ZG3/4"	ZG3/4"	ZG3/4"	ZG3/4"
Max working pressure			MPa	1.6	1.6	1.6	1.6	1.6	1.6	1.6	1.6
Condensate water pipe				DN20 (external thread)							
Net dimension			mm	970*760*425	1050*760*425	1050*760*425	1190*760*425	1190*760*425	1380*760*425	1380*760*425	1640*760*425
Net weight			kgs	47	49	50	54	55	60	61	80

2. Unità con 2 batterie (sistema a 4-tubi) 2. Units with 2 coils (4-pipe system)

Model			VFC80DHC4	VFC100DHC4	VFC120DHC4	VFC140DHC4	VFC160DHC4	VFC180DHC4	VFC200DHC4	VFC240DHC4	
Power supply			220V/50Hz/1Ph Et 220V/60Hz/1Ph								
Air volume	H	m ³ /h	1360	1700	2040	2380	2720	3060	3400	4080	
		CFM	800	1000	1200	1400	1600	1800	2000	2400	
	M	m ³ /h	1090	1360	1635	1900	2180	2450	2720	3260	
		L	m ³ /h	815	1020	1225	1430	1630	1830	2040	2450
Static pressure			Pa	100	100	100	100	100	100	100	
Cooling capacity	TH	H	W	7200	9000	10800	12600	14400	16200	18000	21600
			SH	W	5350	6650	8000	9350	10650	12000	13350
	TH	M	W	5450	6800	8150	9500	10850	12250	13600	16300
			SH	W	3900	4900	5850	6850	7800	8800	9800
	TH	L	W	4200	5250	6300	7350	8400	9450	10500	12600
			SH	W	2950	3700	4450	5200	5950	6650	7400
Heating capacity	H	W	4600	5760	6900	8050	9200	10400	11500	13800	
		M	W	3500	4400	5250	6150	7000	7900	8750	10500
	L	W	3000	3750	4500	5250	6000	6750	7500	9000	
Noise (high speed)			dB(A)	51	51	52	54	56	56	57	
Power input (high speed)			W	380	420	450	520	550	880	900	1100
Water flow	Cooling	m ³ /h		1.23	1.54	1.85	2.16	2.46	2.77	3.08	3.70
	Heating	m ³ /h		0.53	0.66	0.79	0.92	1.06	1.19	1.32	1.58
Pressure dropping			kPa	25	28	30	35	36	42	43	50
			kPa	12	12	14	17	18	21	22	27
Water inlet pipe diameter				ZG3/4"	ZG3/4"	ZG3/4"	ZG3/4"	ZG3/4"	ZG3/4"	ZG3/4"	ZG3/4"
Water outlet pipe diameter				ZG3/4"	ZG3/4"	ZG3/4"	ZG3/4"	ZG3/4"	ZG3/4"	ZG3/4"	ZG3/4"
Max working pressure			MPa	1.6	1.6	1.6	1.6	1.6	1.6	1.6	1.6
Condensate water pipe				DN20 (external thread)							
Net dimension			mm	970*760*425	1050*760*425	1050*760*425	1190*760*425	1190*760*425	1380*760*425	1380*760*425	1640*760*425
Net weight			kgs	49	51	52	56	57	63	64	84

Universal type Fan Coil

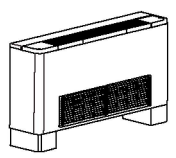
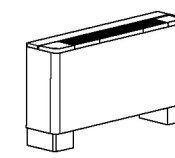
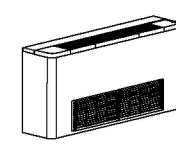
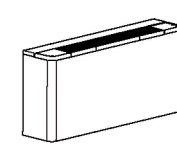

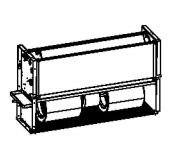
					
VFC..UFLD	VFC..UBLD	VFC..UFD-V VFC..UFD-H	VFC..UBD-V VFC..UBD-H	VFC..UFC-V VFC..UFC-H	VFC..UBC-V VFC..UBC-H

Dimensioni Dimension

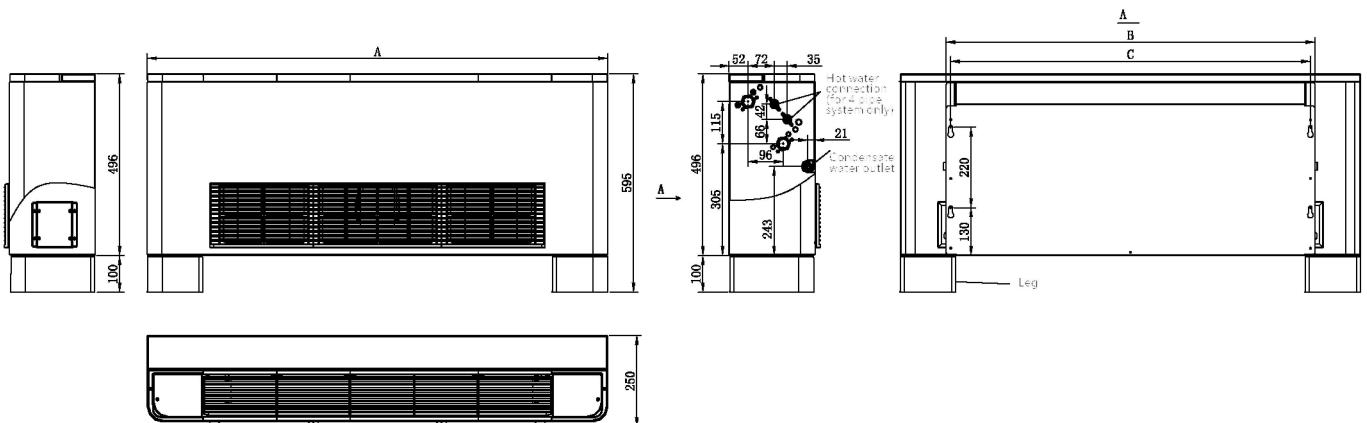

Model	VFC20U	VFC30U	VFC40U	VFC50U	VFC60U	VFC80U	VFC100U	VFC120U	VFC140U
A (mm)	858	908	1058	1208	1258	1608	1758	1908	2058
B (mm)	608	658	808	958	1008	1358	1508	1658	1808
C (mm)	583	633	783	933	983	1333	1483	1633	1783
Fan curve	1	2	2	2	2	4	4	4	4
Motor	1	1	1	1	1	2	2	2	2

Dati tecnici e prestazioni

Performance Technical Data

1. Unità con 1 batteria (sistema a 2-tubi) 1. Units with 1 coil (2-pipes system)

Model		VFC20U-2	VFC30U-2	VFC40U-2	VFC50U-2	VFC60U-2	VFC80U-2	VFC100U-2	VFC120U-2	VFC140U-2		
Power supply		220V/50Hz/1Ph & 220V/60Hz/1Ph										
Air volume	H	m³/h	340	510	680	850	1020	1360	1700	2040	2380	
		CFM	200	300	400	500	600	800	1000	1200	1400	
	M	m³/h	260	390	510	640	770	1020	1280	1530	1790	
		L	m³/h	170	260	340	430	510	680	850	1020	1190
Cooling capacity	TH	H	W	1800	2700	3600	4500	5400	7200	9000	10800	12600
			SH	W	1368	2052	2736	3420	4103	5471	6839	8207
	TH	M	W	1494	2242	2989	3736	4483	5978	7472	8967	10461
			SH	W	1181	1771	2362	2952	3541	4722	5903	7084
	TH	L	W	1162	1744	2325	2906	3487	4649	5812	6974	8136
			SH	W	953	1430	1907	2383	2860	3813	4765	5718
Heating capacity	H	W	2700	4050	5400	6750	8100	10800	13500	16200	18900	
		M	W	2079	3119	4158	5198	6237	8316	10395	12474	14553
		L	W	1634	2450	3267	4084	4901	6534	8168	9801	11435
Noise (high speed)		dB(A)	37	39	41	43	45	46	48	50	52	
Power input (high speed)		W	37	52	62	76	96	134	152	189	228	
Water flow	High speed	m³/h	0.31	0.46	0.62	0.77	0.93	1.23	1.54	1.85	2.16	
Pressure dropping		kPa	16	18	20	23	28	30	33	37	40	
Water inlet pipe diameter			ZG3/4"	ZG3/4"	ZG3/4"	ZG3/4"	ZG3/4"	ZG3/4"	ZG3/4"	ZG3/4"	ZG3/4"	
Water outlet pipe diameter			ZG3/4"	ZG3/4"	ZG3/4"	ZG3/4"	ZG3/4"	ZG3/4"	ZG3/4"	ZG3/4"	ZG3/4"	
Max working pressure		MPa	1.6	1.6	1.6	1.6	1.6	1.6	1.6	1.6	1.6	
Condensate water pipe		mm	16	16	16	16	16	16	16	16	16	

2. Unità con 2 batterie (sistema a 4-tubi) 2. Units with 2coils (4-pipes system)

Model		VFC20U-4	VFC30U-4	VFC40U-4	VFC50U-4	VFC60U-4	VFC80U-4	VFC100U-4	VFC120U-4	VFC140U-4		
Power supply		220V/50Hz/1Ph & 220V/60Hz/1Ph										
Air volume	H	m³/h	340	510	680	850	1020	1360	1700	2040	2380	
		CFM	200	300	400	500	600	800	1000	1200	1400	
	M	m³/h	260	390	510	640	770	1020	1280	1530	1790	
		L	m³/h	170	260	340	430	510	680	850	1020	1190
Cooling capacity	TH	H	W	1800	2700	3600	4500	5400	7200	9000	10800	12600
			SH	W	1368	2052	2736	3420	4103	5471	6839	8207
	TH	M	W	1494	2242	2989	3736	4483	5978	7472	8967	10461
			SH	W	1181	1771	2362	2952	3541	4722	5903	7084
	TH	L	W	1162	1744	2325	2906	3487	4649	5812	6974	8136
			SH	W	953	1430	1907	2383	2860	3813	4765	5718
Heating capacity	H	W	1300	1940	2590	3240	3890	5180	6480	7780	9070	
		M	W	1020	1530	2040	2550	3060	4070	5090	6110	7130
		L	W	820	1230	1630	2040	2450	3270	4080	4900	5720
Noise (high speed)		dB(A)	37	39	41	43	45	46	48	50	52	
Power input (high speed)		W	37	52	62	76	96	134	152	189	228	
Water flow (high speed)	Cooling	m³/h	0.31	0.46	0.62	0.77	0.93	1.23	1.54	1.85	2.16	
	Heating	m³/h	0.11	0.17	0.22	0.28	0.34	0.45	0.56	0.67	0.78	
Pressure dropping	Cooling	kPa	16	18	20	23	28	30	33	37	40	
	Heating	kPa	8	10	12	14	16	20	22	25	28	
Cooled water inlet/outlet pipe			ZG3/4"	ZG3/4"	ZG3/4"	ZG3/4"	ZG3/4"	ZG3/4"	ZG3/4"	ZG3/4"	ZG3/4"	
Hot water inlet/outlet pipe			ZG1/2"	ZG1/2"	ZG1/2"	ZG1/2"	ZG1/2"	ZG1/2"	ZG1/2"	ZG1/2"	ZG1/2"	
Max working pressure		MPa	1.6	1.6	1.6	1.6	1.6	1.6	1.6	1.6	1.6	
Condensate water pipe		mm	16	16	16	16	16	16	16	16	16	

Ultra Thin Vertical Type Fan Coil



Ultra-thin design, 130mm thickness only;

Using cross flow fan, low noise;

Adjustable wind angle;

Inside intelligent LED controller;

With water temperature sensor, cold wind proof design.

Dimensioni Dimension

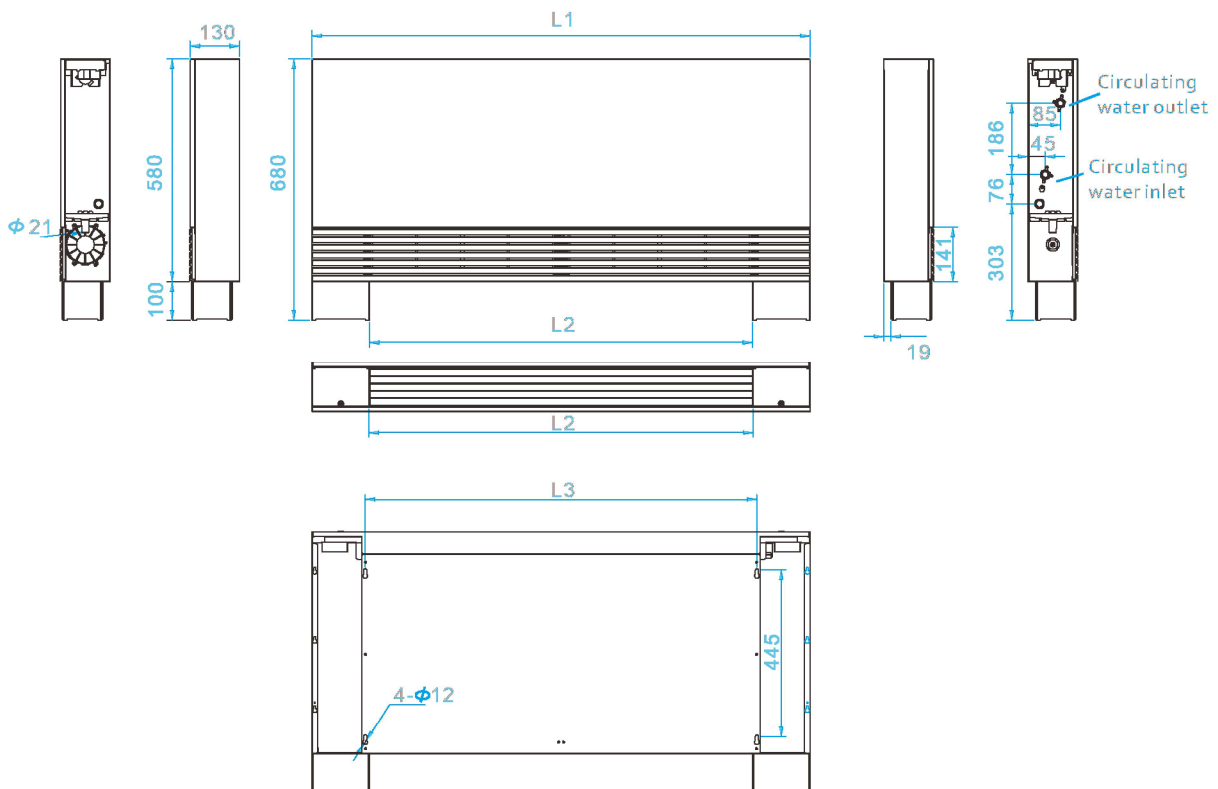

Model	VFC12UTD2	VFC18UTD2	VFC24UTD2	VFC30UTD2	VFC35UTD2
L1 (mm)	700	900	1100	1300	1500
L2 (mm)	400	600	800	1000	1200
L3 (mm)	422	622	822	1022	1222

Dati tecnici e prestazioni

Performance Technical Data

Model		VFC12UTD2	VFC18UTD2	VFC24U-2	VFC30U-2	VFC35U-2		
Power supply		220V/50Hz/1Ph & 220V/60Hz/1Ph						
Air volume	H	m ³ /h	200	300	400	500	600	
		CFM	120	180	240	300	350	
	M	m ³ /h	150	220	300	380	450	
		L	m ³ /h	110	160	230	290	340
Static pressure		Pa	0	0	0	0		
Cooling capacity	TH	H	W	1000	1800	2400	3000	3600
			W	713	1283	1711	2139	2567
	SH	M	W	800	1440	1920	2400	2880
			W	555	999	1330	1660	1990
	TH	L	W	650	1170	1560	1950	2340
			W	430	770	1025	1280	1535
Heating capacity	H	W	W	1600	2900	3850	4800	5750
			W	1280	2320	3080	3840	4600
	L	W	830	1510	2000	2500	2990	
Noise (high speed)		dB(A)	38	39	40	41	42	
Power input (high speed)		W	15	18	20	26	32	
Water flow	High speed	m ³ /h	0.17	0.26	0.34	0.43	0.51	
Pressure dropping		kPa	4	6	8	10	12	
Water inlet pipe diameter			ZG 1/2"	ZG 1/2"	ZG 1/2"	ZG 1/2"	ZG 1/2"	
Water outlet pipe diameter			ZG 1/2"	ZG 1/2"	ZG 1/2"	ZG 1/2"	ZG 1/2"	
Max working pressure		MPa	1.6	1.6	1.6	1.6	1.6	
Condensate water pipe		mm	21	21	21	21	21	
Net dimension		mm	700*130*681	900*130*681	1100*130*681	1300*130*681	1500*130*681	
Net weight		kgs	14.5	18.5	21.5	24	27	



AirWave

via Posillipo,
69/34 80123
Napoli, Italia

info@airwavehvac.com
www.airwavehvac.com